

SEMI-RECESSING KIT

JOB #:
 ITEM #:
 QTY:

MOUNTING	HANDING	TYPE	SIZE	OTHER
----------	---------	------	------	-------

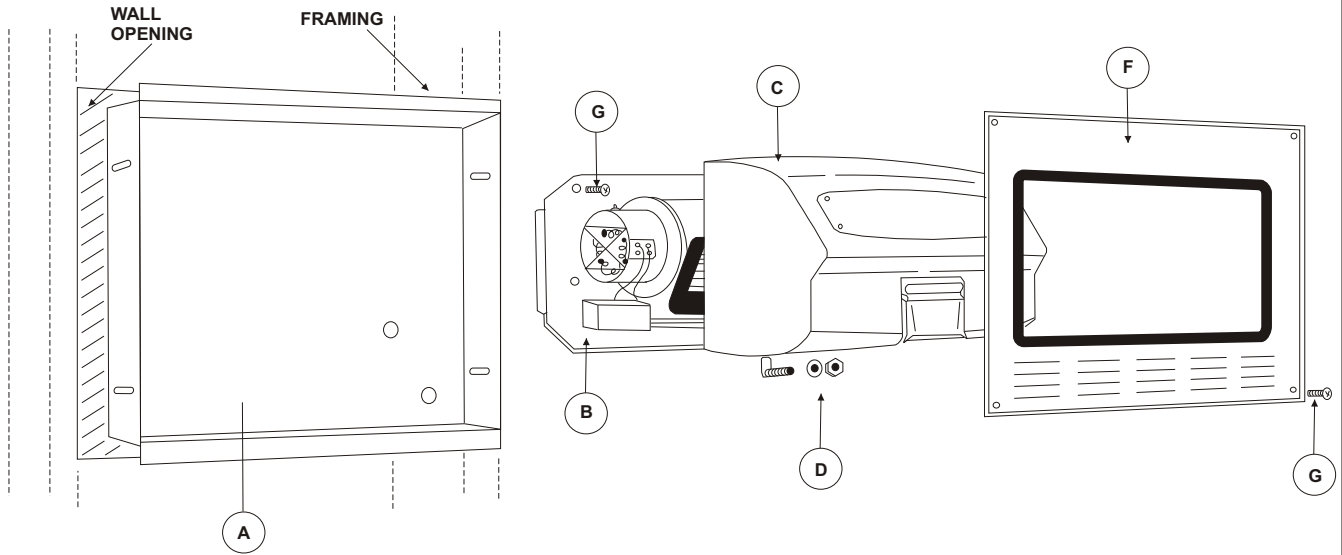

SPECIFICATIONS:

This semi-recessing kit will convert a surface mounted hand / hair dryer to semi-recessed. If a dryer has been surface mounted and later the dryer needs to be semi-recessed, this kit can be ordered to go along with the existing dryer in the field.

Recessing Box: A: Galvanized steel box with knock-out locations to handle power supply. Dryer base is secured to box.

Face Plate: B: Type 304 #20 ga stainless steel with a 8B finish. Plate is equipped with louvers to provide air flow and a rubber gasket to provide a snug fit around dryer cover.

Recessing Kit	Qty	Dryers to Convert
U019A _____	_____	U1523, U1523EA
U020A _____	_____	U1525, U1525EA
U021A _____	_____	U1521, U1521EA

Face Plate: 16"W x 13"H (406mm x 330mm)

Recessing Box: 14 1/2"W x 12"H x 2 1/2"D
(365mm x 264mm x 64mm)

Wall Opening: 14 5/8"W x 12 1/8"H x 2 5/8"D
(373mm x 264mm x 68mm)

INSTALLATION:

Provide a wall opening at desired or specified location. See hand dryer technical data sheet for proper wall opening required and proper mounting height for each application. Remove dryer cover and mount base to recessing box. Place unit in wall opening and connect power supply. *(Electrical connection must be completed by qualified, licensed electrician)* Test dryer. If dryer checks good, install cover. Test dryer again after cover is secured. Secure cover with supplied theft resistant fasteners. Remove vinyl covering and slide face plate over dryer cover until flush with wall surface. Test dryer and secure face plate.

APPLICATION:

To provide a semi-recessing kit when full surface mounted dryers are not applicable.

